

FUSE CLIP P.C.BOARD TYPE FOR
ATS BLADE FUSE

SPECIFICATIONS:

- *Electical:Rating for currents up to 15A
- *Material:Phosphor Bronze Thickness=0.3mm
- *Finish:Tin-plated or Nickel-plated
- *Ear or earless type, with axial and direction tags.

#Specifications :

- 1.Insertion & Extraction Force=1kg.Min.
- 2.Dielectric Strength For 60 Seconds=AC 500 V Min.
- 3.Suitable Rated Current=15A 250V
- 4.Insulation Resistance At 500 V DC=100M Ω Min
- 5.Temperature Rise=50°C Max.
- 6.Voltage Drop=20m V Max.

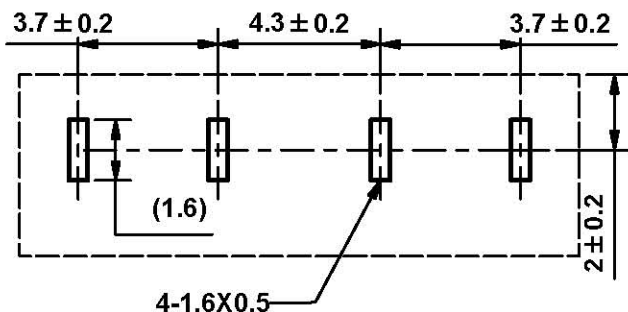
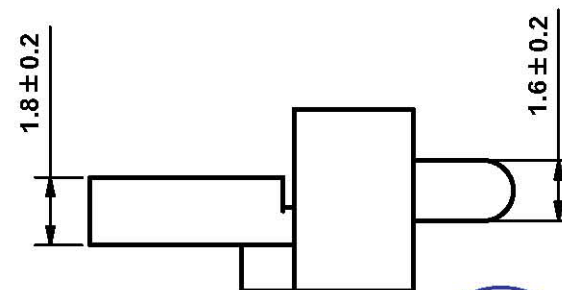
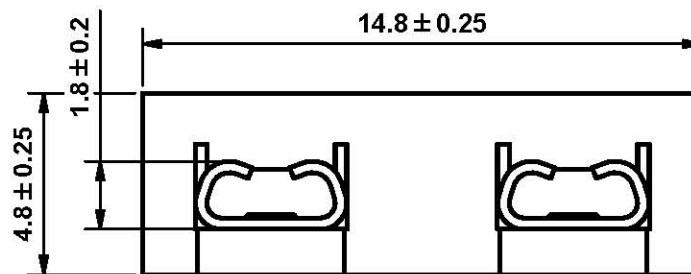
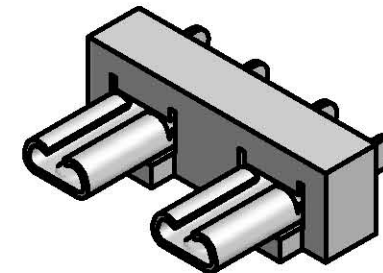
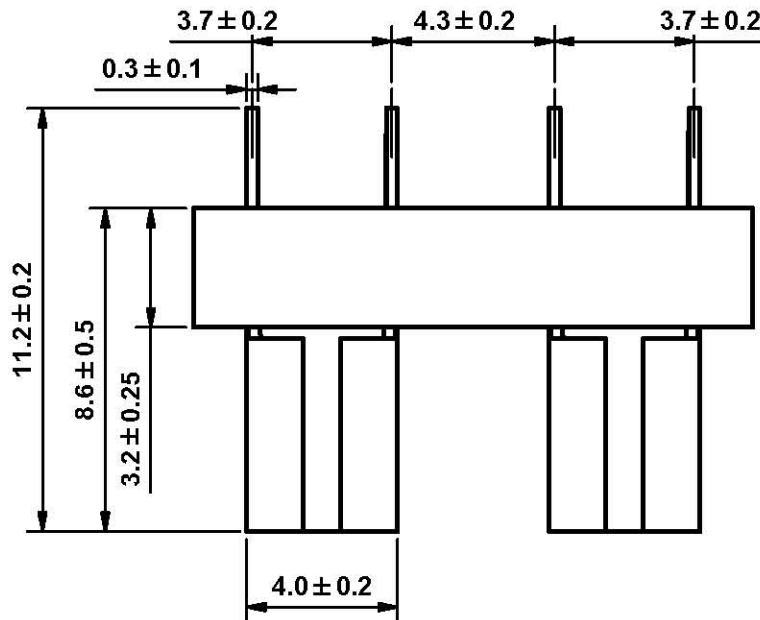

MOUNTING HOLES



UNLESS OTHERWISE SPECIFIED DIMENSIONS ARE IN MM TOLERANCE DECIMALS ANGULAR X±0.5 ±2° XX±0.25 DO NOT SCALE DRAWING		CUSTOMER NO.	TITLE FUSE CLIPS
		DRAWN BY 施素玲	
 		CHECKED BY	
		APPROVED BY 鄭文和	
MATERIAL		DATE 2004/11/9	PART NO. 600-090
REV	1.1	SCALE	DRAWING NO. AA04110901